

| | | | |
|---|---|---|--|
| 1 | 2 | 3 | |
|---|---|---|--|

SPECIFICATIONS

Voltage rating: AC 250V DC
 Current rating: AC,DC,3A
 Withstand voltage: AC 1000 V/min.
 Insulation resistance: 1000MΩ min.
 Temperature range: -40° C~+105° C
 (ENVIRONMENTS TEMPERATURE)

Applicable PC board thickness: 0.8~1.6mm
 Contact resistance: Initial value/10 mΩ max.
 After environmental Testing/20mΩ max.

HOUSING

Part No:
 Poles: 2-20
 Material: Nylon 66, UL94V-0

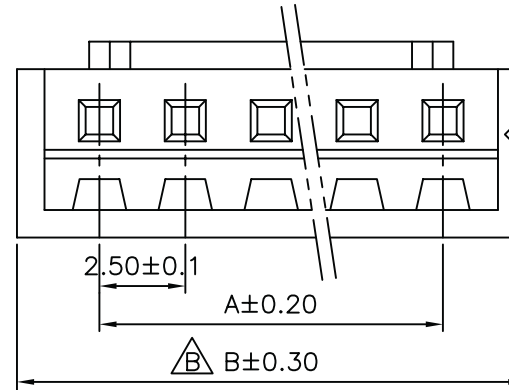
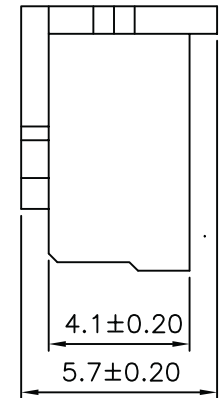
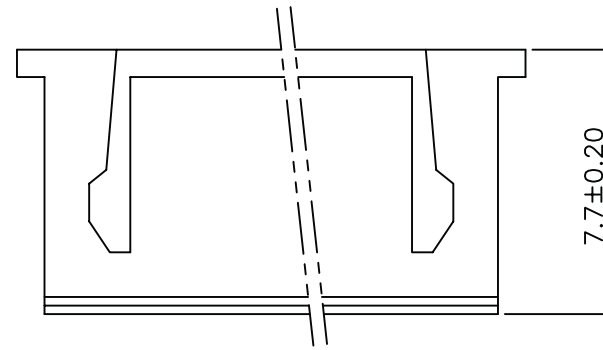

| Poles | Part No. | Dimension in.(mm) | | Material |
|-------|-----------|-------------------|-------------|---|
| | | A | B | |
| 2 | 2503-H-2 | 0.098(2.5) | 0.295(7.5) | Post: Brass Tin/Plated Base: Nylon 66 UL94V-0 |
| 3 | 2503-H-3 | 0.197(5.0) | 0.394(10.0) | |
| 4 | 2503-H-4 | 0.295(7.5) | 0.492(12.5) | |
| 5 | 2503-H-5 | 0.394(10.0) | 0.591(15.0) | |
| 6 | 2503-H-6 | 0.492(12.5) | 0.689(17.5) | |
| 7 | 2503-H-7 | 0.591(15.0) | 0.787(20.0) | |
| 8 | 2503-H-8 | 0.689(17.5) | 0.886(22.5) | |
| 9 | 2503-H-9 | 0.787(20.0) | 0.984(25.0) | |
| 10 | 2503-H-10 | 0.886(22.5) | 1.083(27.5) | |
| 11 | 2503-H-11 | 0.984(25.0) | 1.181(30.0) | |
| 12 | 2503-H-12 | 1.083(27.5) | 1.280(32.5) | |
| 13 | 2503-H-13 | 1.181(30.0) | 1.378(35.0) | |
| 14 | 2503-H-14 | 1.280(32.5) | 1.476(37.5) | |
| 15 | 2503-H-15 | 1.378(35.0) | 1.575(40.0) | |
| 16 | 2503-H-16 | 1.476(37.5) | 1.673(42.5) | |
| 17 | 2503-H-17 | 1.575(40.0) | 1.771(45.0) | |
| 18 | 2503-H-18 | 1.673(42.5) | 1.870(47.5) | |
| 19 | 2503-H-19 | 1.771(45.0) | 1.968(50.0) | |
| 20 | 2503-H-20 | 1.870(47.5) | 2.066(52.5) | |

| | | | | | | | | | |
|-----|------|------|--------|----------|--------------------|--|--------------|---------|--|
| | | | | DRAWN: | GENERAL TOLERANCE: | | | | |
| E | | | | | | | | | |
| D | | | | | | | | | |
| C | | | | CHECKED: | UNIT: | | | SIZE | |
| B | | | | | SCALE: | | | A4 | |
| A | | | JECSON | | SHEET: | | DESCRIPTION: | | |
| REV | Date | FILE | BY | | PROJECTION: | | PART NO: | F11-xxP | |

A
B
C
D